

LOCATION

THE FRANKLIN COUNTY RE-USE CENTER IS
LOCATED AT 13042 US HIGHWAY 52, JUST 1.5
MILES WEST OF BROOKVILLE.
PHONE: 812.599.6146

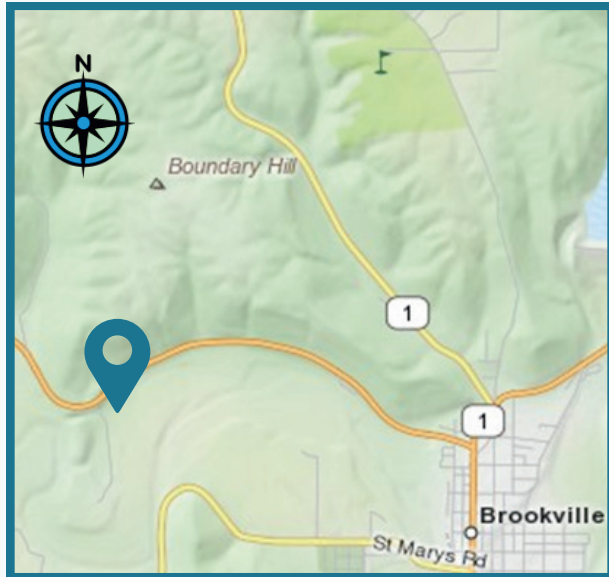

HOURS

TUESDAY AND THURSDAY
9:00 AM – 3:00 PM

2025 HOLIDAY CLOSINGS

VETERANS DAY, NOVEMBER 11
THANKSGIVING, NOVEMBER 27
CHRISTMAS DAY, DECEMBER 25

**DONATIONS ARE ONLY
ACCEPTED DURING REUSE
CENTER BUSINESS HOURS!**

ABOUT US

The Southeastern Indiana Recycling District exists to serve the people of Franklin, Jefferson, Jennings, Ohio, Ripley, Scott and Switzerland Counties. Our mission is to preserve and enhance our environment, natural resources, and public health and safety by leading in the proper management of solid waste. This may be accomplished through the practice of recycling, the reuse of satisfactory items and ultimately the reduction of materials entering our landfills. Together we are partners in protecting the earth. Following is a sampling of some of the many activities of SEIRD.....

- Operates 8 recycling & 7 re-use facilities.
- Collects recyclables from over 60 schools.
- Provides grants to cities / towns within the district to underwrite local recycling programs.
- Provides a place to dispose of difficult-to-recycle items, such as HHW, tires, chemicals, used oil / filters, refrigerants, electronics, etc.
- Extensive educational outreach / programs.

For more about recycling opportunities in your county please visit www.seird.org



SOUTHEASTERN INDIANA RECYCLING DISTRICT
6556 NORTH SHUN PIKE RD. JPG #534
MADISON, IN 47250
812.574.4080 800.997.4793
WWW.SEIRD.ORG

FRANKLIN COUNTY RE-USE CENTER



**A "FREE STORE" FOR THE
RESIDENTS OF FRANKLIN
COUNTY, INDIANA**

**SPONSORED BY THE
SOUTHEASTERN INDIANA
RECYCLING DISTRICT.**

SHOPPING GUIDELINES

This facility is provided for the residents of Franklin County to share / swap / exchange items that are in good, usable condition.



PLEASE OBSERVE THESE SIMPLE RULES:

- **SHOPPING IS LIMITED TO ONE VISIT PER WEEK**
- **PLEASE LIMIT SHOPPING TIME TO 20 MINUTES.**
- **ITEMS TAKEN ARE NOT TO BE SOLD.**
- **THERE IS A LIMIT OF 4 ITEMS PER PERSON - EXCEPT CLOTHING.**
- **LIMIT OF 5 BOOKS.**
- **PLEASE HELP KEEP CLOTHING NEATLY FOLDED OR HUNG UP.**
- **PLEASE RESPECT THE GENEROSITY OF OTHERS. TAKE ONLY WHAT YOU NEED.**
- **FAILURE TO ABIDE BY THE GUIDELINES WILL RESULT IN PERMANENT DISMISSAL FROM THE STORE.**

THIS IS A SMOKE/ALCOHOL/DRUG FREE FACILITY. PLEASE NO FOOD OR DRINK IN STORE.

DONATION GUIDELINES

This "free store" is possible due to the generous contributions of people throughout the community. If you have good, usable items that are no longer needed please consider donating them to the Franklin County Re-Use Center so that they might be put to good use.

PLEASE CONSIDER THESE GUIDELINES REGARDING DONATIONS TO THE CENTER

ITEMS ACCEPTED:

- **WORKING HOUSEHOLD APPLIANCES, HAND TOOLS, LAWNMOWERS AND RELATED EQUIPMENT.**
- **EXERCISE EQUIPMENT, BICYCLES, ETC.**
- **CLEAN CLOTHING**
- **BOOKS**
- **HOUSEHOLD ITEMS & KNICK KNACKS**
- **HOUSEWARES**
- **TOYS**

PLEASE DROP OFF DONATIONS DURING BUSINESS HOURS ONLY

DONATION GUIDELINES

PLEASE DO NOT BRING THE FOLLOWING ITEMS TO THE RE-USE CENTER:

- **SOILED OR MILDEWED ITEMS**
- **CLOTHING OR SHOES THAT ARE TORN, SOILED, OR RIPPED**
- **HATS OR UNDERCLOTHING**
- **UPHOLSTERED FURNITURE, BEDDING, MATTRESSES, PILLOWS**
- **BOOKS WITH MISSING PAGES / COVERS**
- **POTENTIALLY HAZARDOUS ITEMS DUE TO FLAWS OR FAULTS**
- **FOOD ITEMS**



RECYCLING OPPORTUNITIES

A DIFFERENT WAY TO RECYCLE !!!

The Franklin County Re-Use Center provides an alternative way for items to be "recycled". Bring something in, take something out! All items left at the center are available to any Franklin County resident at no cost. Items from the center are not intended to be resold. Please respect the generosity of others.